

9-HOLE CORDING FOOT

Part: 202506003 - For 9 mm (max.) stitch width models

Sewing with 7/5 cords - Machine Settings

Stitch patterns: Multiple zigzag stitch or quilt stitches

Stitch width: 7 - 8 (7 cords), 5 - 6.5 (5 cords)

Sewing speed: Low to middle

Make sure to test sewing first.



Preparation

Use the needle threader from the bottom of the foot for threading the cords through the 7 holes (00000) or 5 holes (00000)

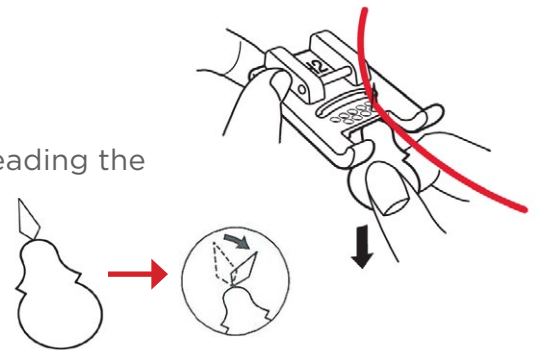

Sewing Instructions

- 1 Place the fabric under the foot holder.
- 2 Attach the foot with inserted 7 or 5 cords.
 - Pull the cords approximately 1 inch (2 cm) behind the presser foot.
 - Pull the needle thread under and to the left of the foot so as not to tangle the thread with the cords.
 - Arrange the cords in the front of the foot so as not to tangle the cords.
- 3 Sew while guiding the fabric and cords so as not to tangle the front cords.
 - Decrease the stitch width if the stitch sticks out from the cord.
 - Increase the stitch width if the cord is not firmly attached.

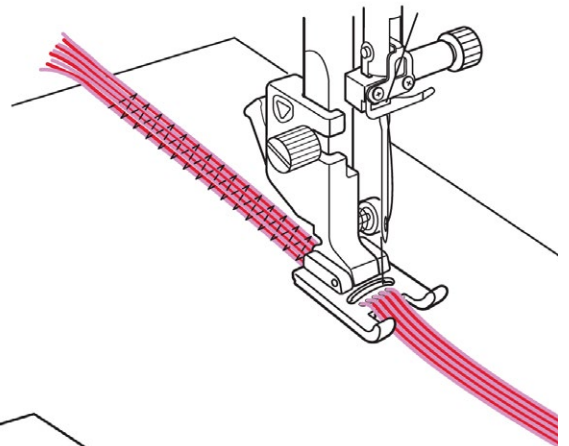

Curve Sewing

Increase the stitch length or change the stitch pattern if the stitches are too congested.

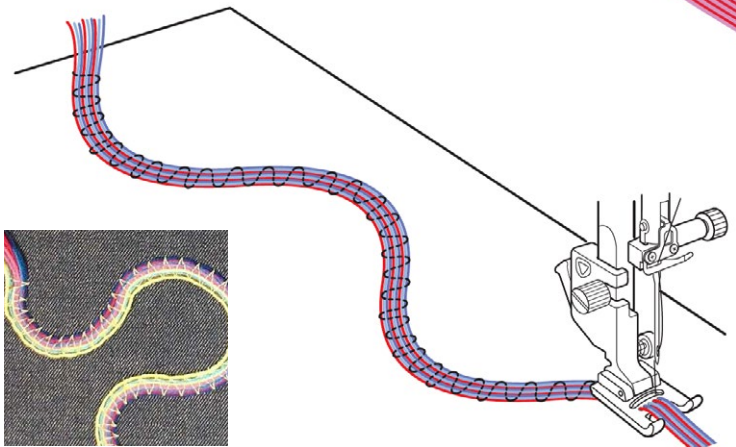
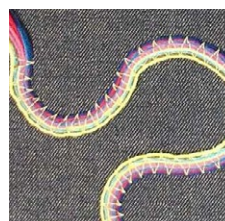
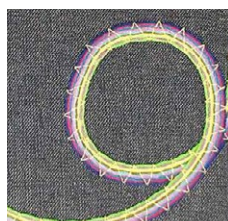

9-HOLE CORDING FOOT

Part: 202506003 - For 9 mm (max.) stitch width models

Corner Sewing - Machine Settings

Stitch patterns: Multiple zigzag stitch
Stitch width: 9 (9 cords),
7 - 7.5 (7 cords), 5 - 6 (5 cords)
Sewing speed: Low to middle

Make sure to test sewing first.



Preparation

Use the needle threader from the bottom of the foot for threading the cords through the 9 holes (●●●●●●●●●), 7 holes (○●●●●○) or 5 holes (○●●●○) of the foot.

Sewing Instructions

- 1 Place the fabric under the foot holder.
- 2 Attach the foot with inserted cords.
 - Pull the cords approximately 1 inch (2 cm) behind the presser foot
 - Pull the needle thread under and to the left of the foot so as not to tangle the thread with the cords.
 - Arrange the cords in the front of the foot so as not to tangle the cords.
- 3 Being careful not to get tangled in the front cords, sew until the outer edge of the cornering pattern.
- 4 Sew the reverse stitch until the inner edge of the cornering pattern.
- 5 Lower the needle into the fabric. Raise the presser foot slightly and turn the fabric 90°.
- 6 Arrange the cords. Be sure that cords are tight and there is no tangling.
- 7 Sew the reverse stitch until the outer edge of the cornering pattern.
- 8 Continue sewing.
 - Decrease the stitch width if the stitch sticks out from the cord.
 - For 7 or 5 cords, increase the stitch width if the cord is not firmly attached.

